

HLAVNÍ PROJEKTANT:



Energy Benefit Centre a.s.
Křenova 438/3, 162 00 Praha 6
tel.: +420 270 003 300
e-mail: kontakt@energy-benefit.cz
internet: www.energy-benefit.cz

Hlavní projektant:
Ing. Libor Truhelka
Zástupce hlavního projektanta:
Ing. Vladimír Fiedler
Hlavní architekt:
Ing. arch. Petr Ovčáčík

ZPRACOVATEL ČÁSTI:



Q PROJEKT
Bohuslava ze Švamberka 1229/8
140 00 Praha 4
tel./fax: +420 261 216 619
e-mail: q-projekt@q-projekt.cz

Vypracoval:
Ing. Jan Macek
Zodpovědný projektant:
Ing. Jaroslav Borovička

STAVEBNÍK:

Univerzita Karlova, Právnická fakulta
nám. Curieových 901/7, 116 40 Praha 1, IČ: 00216208

PROJEKT:

UK - PF - REKONSTRUKCE OKEN, FASÁDY A VENKOVNÍCH PRVKŮ

MÍSTO STAVBY: Nám. Curieových 7, 116 40 Staré Město, pozemek parc. č. 990 k.ú. Staré Město [727024]

OBJEKT:

SO-02 ČÁST OKNA A ANGLICKÉ DVORKY

ČÁST, PROFESE:

D.1.1. ARCHITEKTONICKO STAVEBNÍ ŘEŠENÍ - ČÁST OKNA A ANGLICKÉ DVORKY

VÝKRES:

D.1.1.2. PŮDORYSY

razítko a podpis

Zakázkové číslo:

220253

Paré:

Datum:

15.12.2023

Stupeň:

DPS

Měřítko:

1:250

ID PROJEKTU_STUPEŇ_OBJEKT_ID PROFESE_PROFESE-ČÍSLO_OBSAH:

UKPF_DPS_SO-02_D.1.1.2. PŮDORYSY

IDENTIFIKÁTOR VÝPLNĚ OTVORU

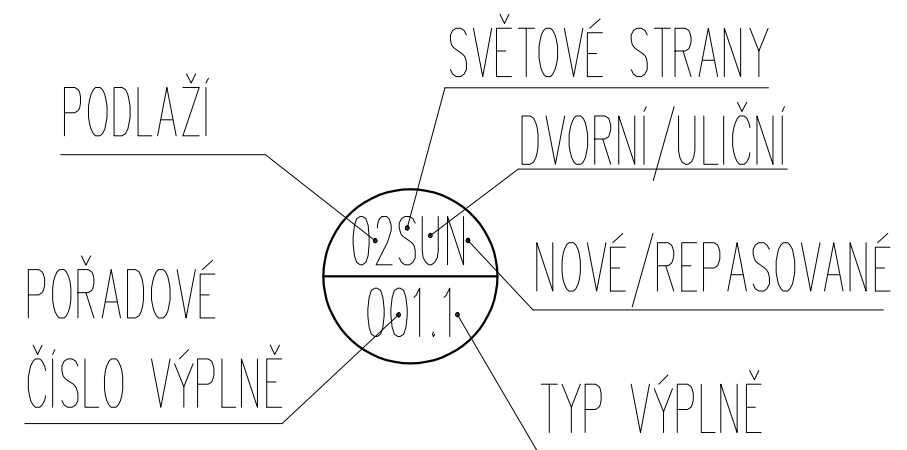

DVOŘÁKOVO NÁBŘEŽÍ

2.PP

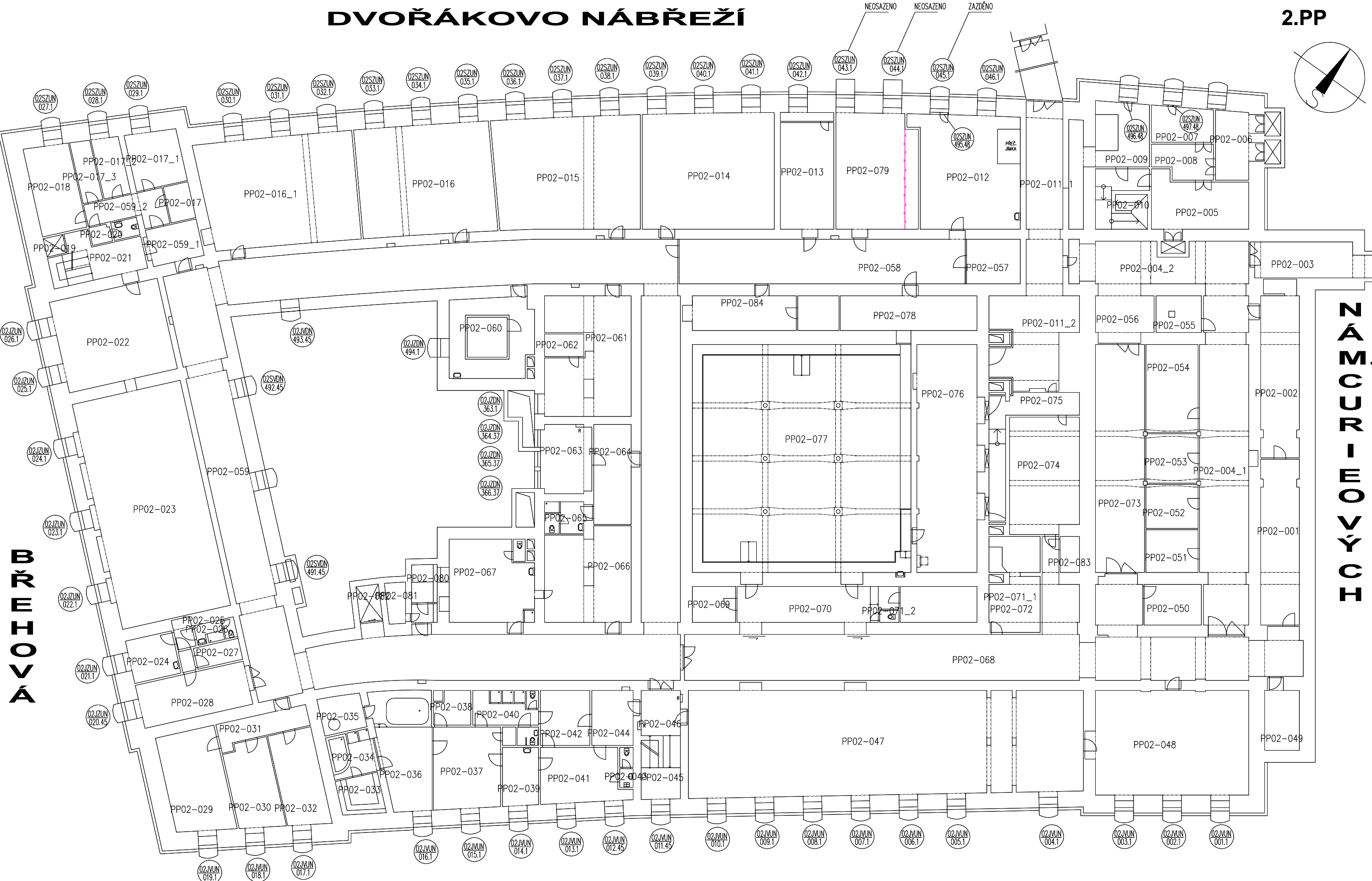
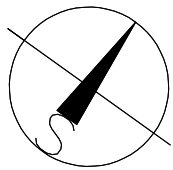

BRNO

NÁM.
M.
R.
O.
V.
O.
Y.
I.
C.
O.
M.

17.LISTOPADU

Architectural floor plan of a building, likely a residential or institutional structure, showing numerous rooms and corridors. The plan is oriented with a North arrow pointing towards the top right, labeled "1.PP".

The building is surrounded by a wall with many windows. The rooms are arranged in a grid-like fashion, with some larger rooms and many smaller ones. The plan also shows various mechanical and electrical symbols, including pumps, valves, and electrical outlets.

Rooms are labeled with codes such as PP01-001, PP01-002, PP01-003, PP01-004, PP01-005, PP01-006, PP01-007, PP01-008, PP01-009, PP01-010, PP01-011, PP01-012, PP01-013, PP01-014, PP01-015, PP01-016, PP01-017, PP01-018, PP01-019, PP01-020, PP01-021, PP01-022, PP01-023, PP01-024, PP01-025, PP01-026, PP01-027, PP01-030, PP01-031, PP01-032, PP01-033, PP01-034, PP01-035, PP01-036, PP01-037, PP01-038, PP01-039, PP01-040, PP01-041, PP01-042, PP01-043, PP01-044, PP01-045, PP01-046, PP01-047, PP01-048, PP01-049, PP01-050, PP01-051, PP01-052, PP01-053, PP01-057, PP01-058, PP01-062, PP01-065, PP01-066, PP01-067, PP01-068, PP01-069, PP01-070, PP01-071, PP01-072, PP01-073, PP01-074, PP01-075, PP01-076, PP01-077, PP01-078, PP01-079, PP01-080, PP01-081, PP01-082, PP01-083, PP01-084, PP01-085, PP01-086, PP01-087, PP01-088, PP01-089, PP01-090, PP01-091, PP01-092, PP01-093, PP01-094, PP01-095, PP01-096, PP01-097, PP01-098, PP01-099, PP01-100, PP01-101, PP01-102, PP01-103, PP01-104, PP01-105, PP01-106, PP01-107, PP01-108, PP01-109, PP01-110, PP01-111, PP01-112, PP01-113, PP01-114, PP01-115, PP01-116, PP01-117, PP01-118, PP01-119, PP01-120, PP01-121, PP01-122, PP01-123, PP01-124, PP01-125, PP01-126, PP01-127, PP01-128, PP01-129, PP01-130, PP01-131, PP01-132, PP01-133, PP01-134, PP01-135, PP01-136, PP01-137, PP01-138, PP01-139, PP01-140, PP01-141, PP01-142, PP01-143, PP01-144, PP01-145, PP01-146, PP01-147, PP01-148.

Other labels include "BETHOVEN" (vertical text on the left) and "NAMUR-BOYCH" (vertical text on the right).

NĂM. CURIEOVÝCH

17.LISTOPADU

DVOŘÁKOVO NÁBŘEŽÍ

1.NP

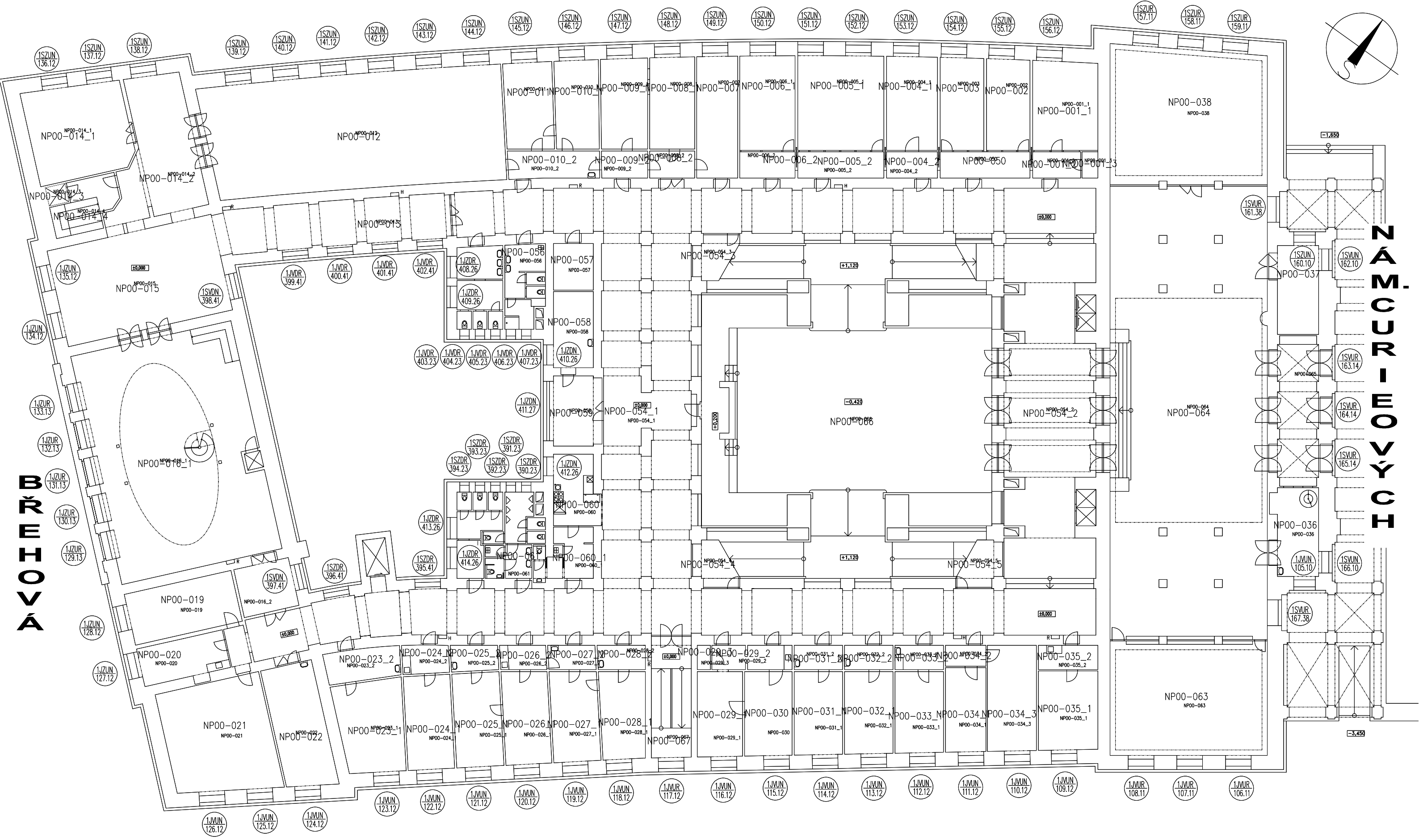

17.LISTOPADU

2.NP

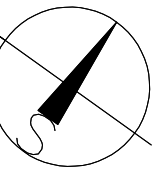

**N
Á
M.
C
U
R
I
E
O
V
Ý
C
H**

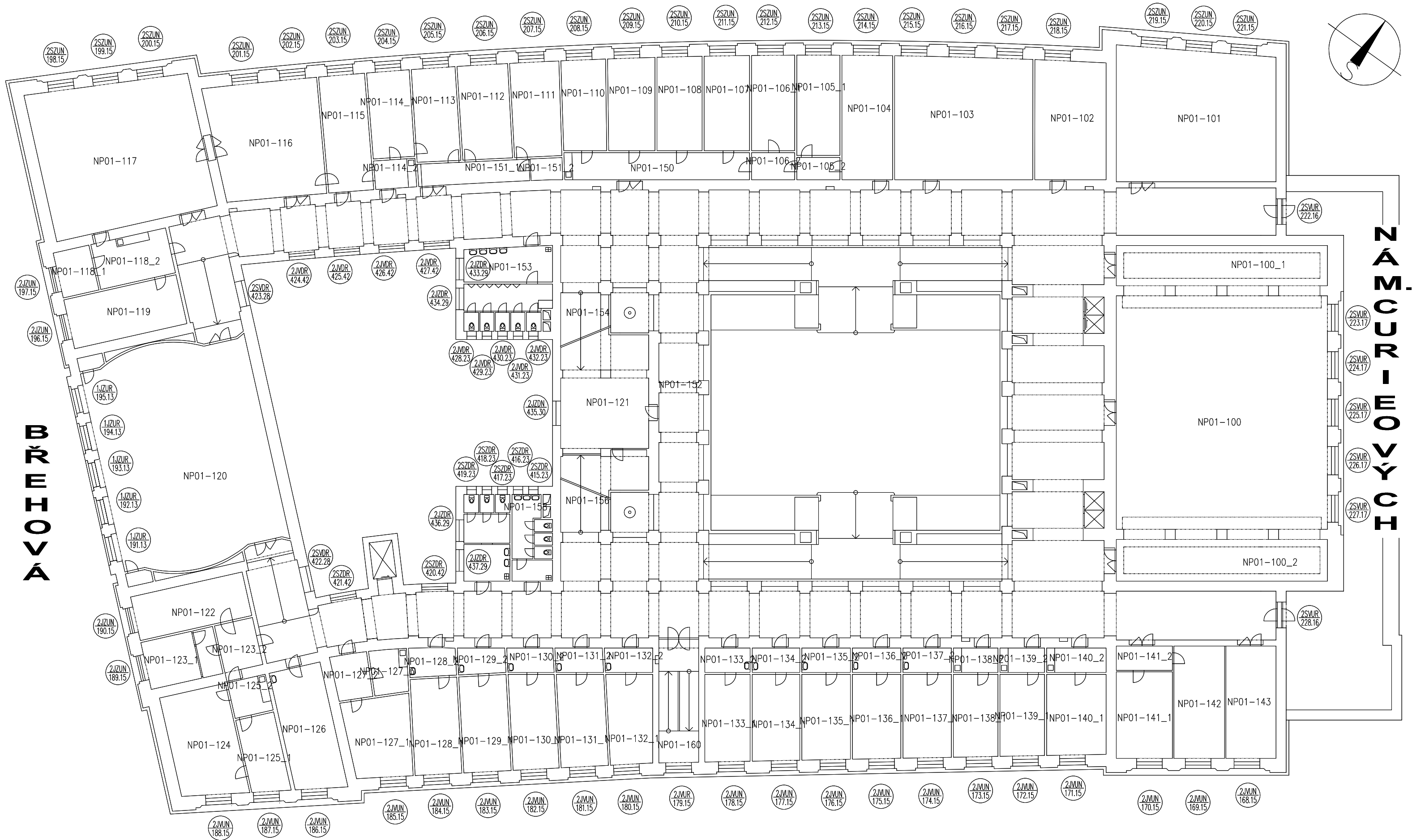

17.LISTOPADU

DVOŘÁKOVO NÁBŘEŽÍ

3.NP

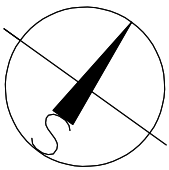

BOVO
NÁBŘEŽÍ

NÁM.
C-
R-
E-
O-
V-
O-
H

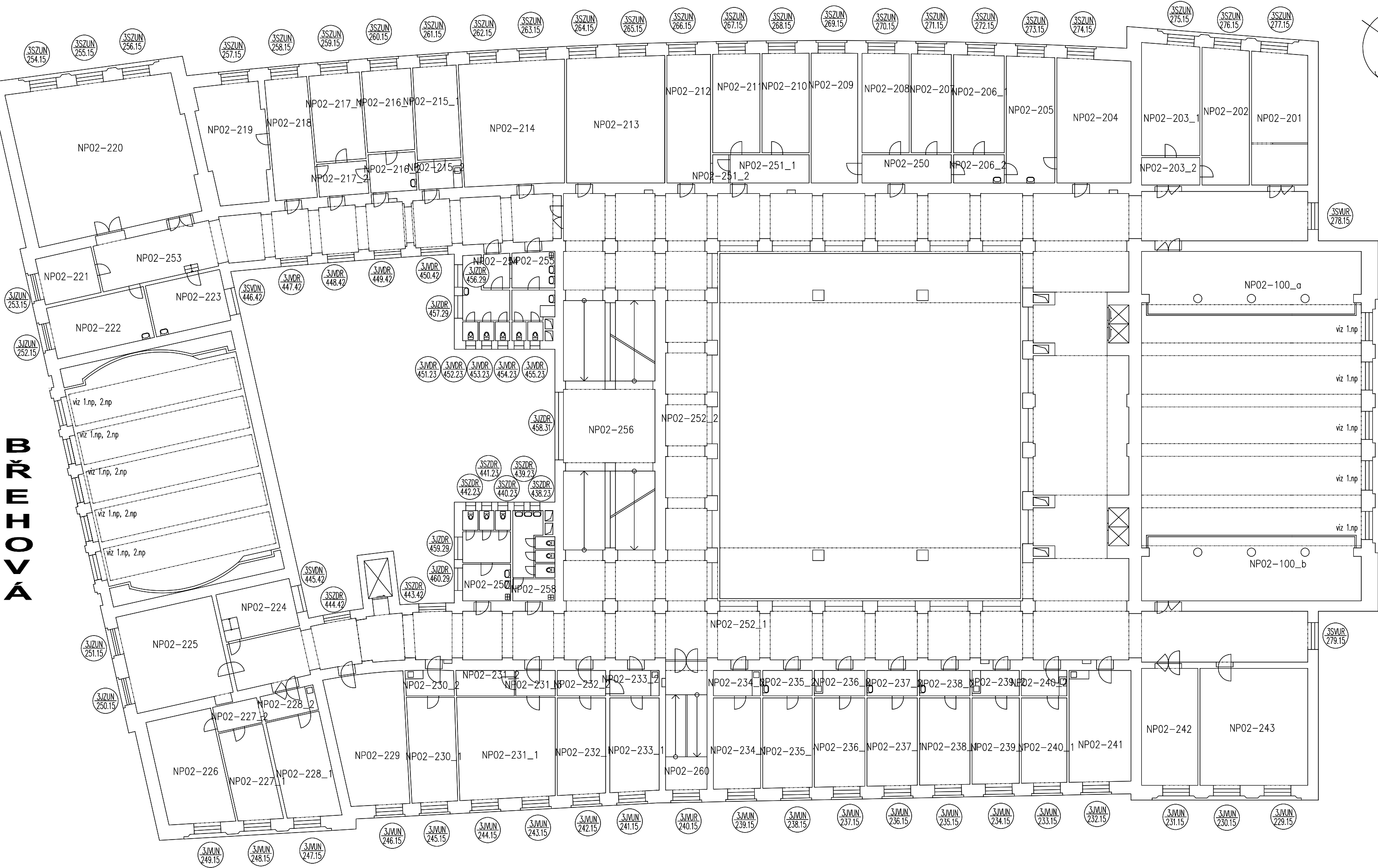

17.LISTOPADU

4.NP

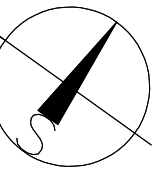

NÁM. CURIEOVÝCH

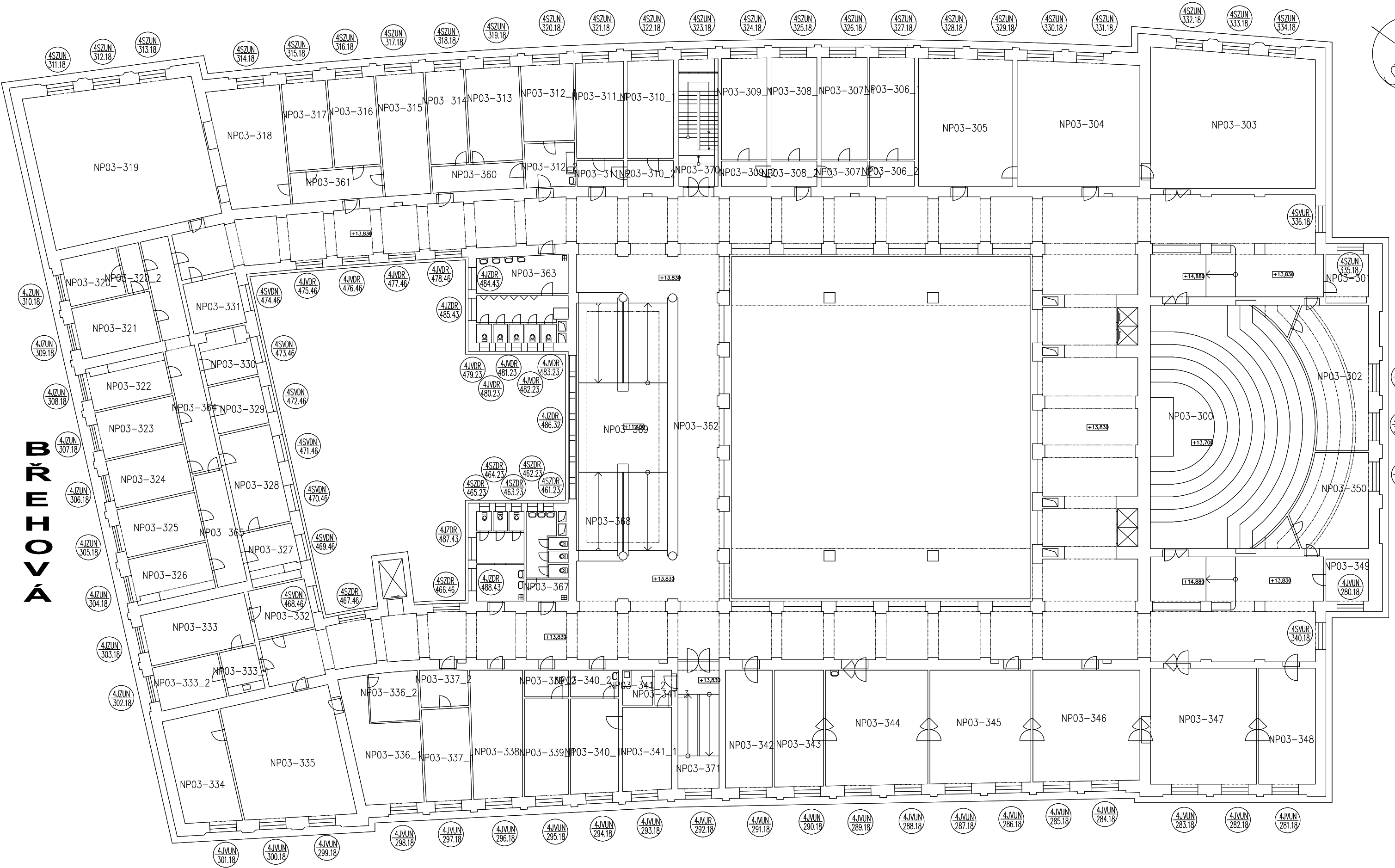

17.LISTOPADU

DVOŘÁKOVO NÁBŘEŽÍ

5.NP

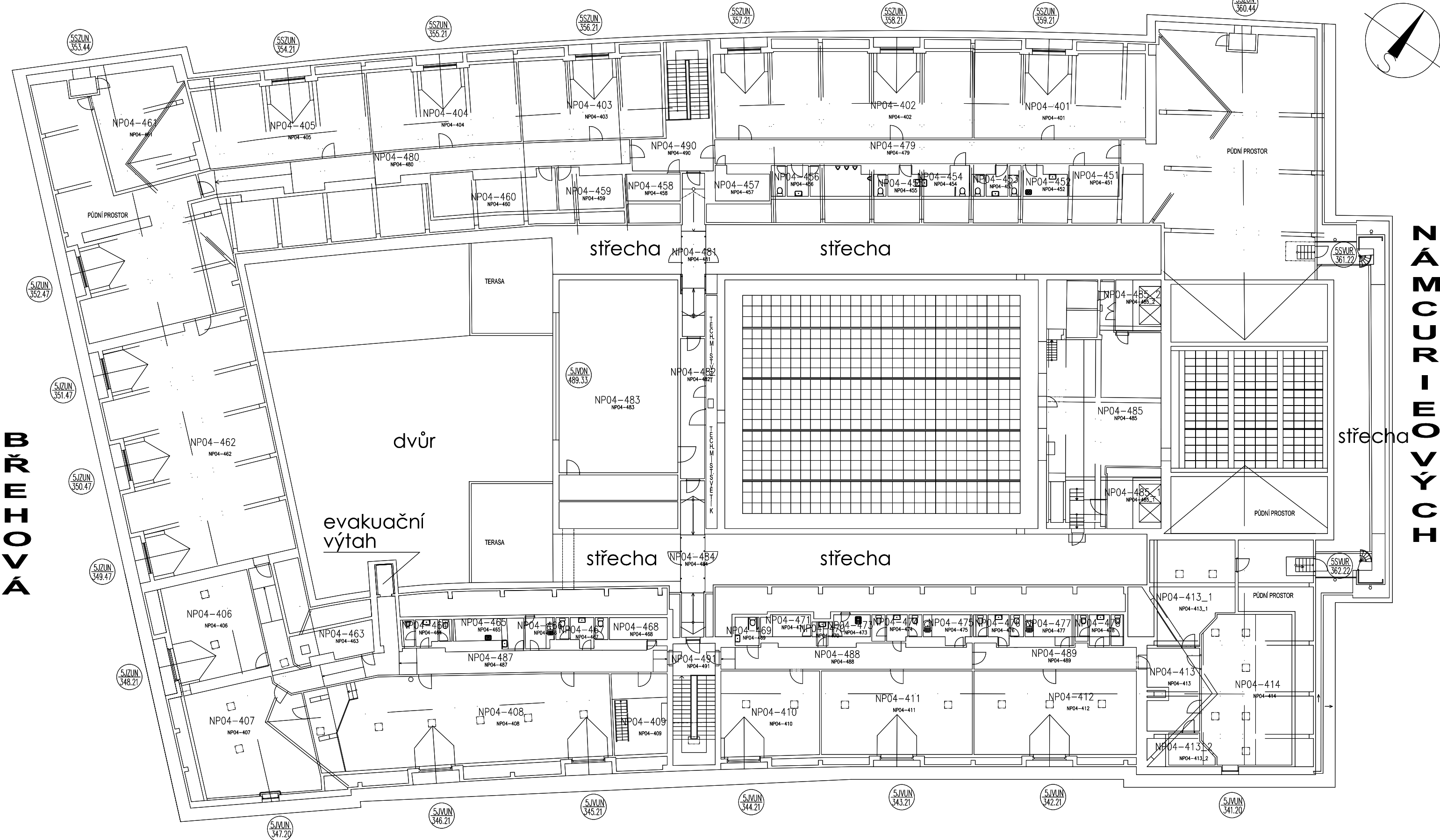

DVOŘÁKOVO NÁBŘEŽÍ

DVOŘÁKOVO NÁBŘEŽÍ